

SPC Tilt N Turn Egress Windows

Authentic European Window

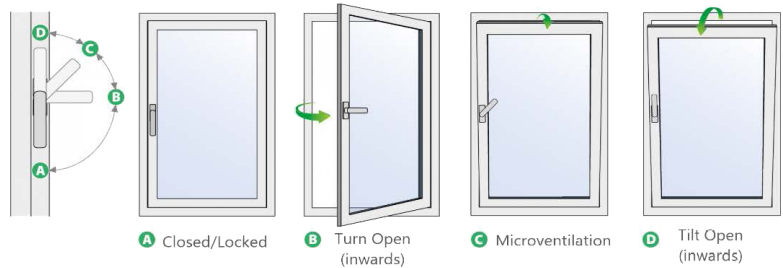

U-Factor (USA)	Solar Heat Gain Coefficient (SHGC) (Euro)	Aire Permeability (Euro)	Visible Transmittance
0.25			
U-Factor (Metric)	0.61	Class C2	0.82
1.41			



Window Size Offering

Net Clear Opening 6.21 SQ FT

29.5" x 41.5" - Right Hand

29.5" x 41.5" - Left Hand

Net Clear Opening 7.23 SQ FT

29.5" x 47.5" - Right Hand

29.5" x 47.5" - Left Hand

Energy Efficiency

- **Rated U-Factor: 0.25**

Energy Star, U-factor values generally range from 0.25 to 1.25. Values 0.30 or lower are considered very energy-efficient.

Window Glass

- **SHGC Rating .061**

Our window is designed with dual 4 mm glass panes for an overall IGU Thickness of 24 mm and the Solar Heat Gain Coefficient (SHGC) is rated at .061. A product with a high SHGC rating is more effective at collecting solar heat during the winter. Solar Transmittance rating of 64%.

Window Construction

- **Steel Reinforced Frame**

The Tilt & Turn window frame is built with uPVC and with a steel reinforced frame. Made from highly chemically resistant veneer, Weather Resistant. Fixed full screen.

Safety

- **Added Option of Laminated Glass**
- **Full Profile Bonding Technology**

Sound

- **Sound Dampening Rated at 34dB**

The quality window design provides an added benefit of sound dampening, rated at 34dB.

Burglary resistance is an important point to be considered when buying new windows as, in most cases, this is where thieves tend to break in. Key features such as the innovative sash design, with the added option of laminated glass and a full profile bonding technology provides superior protection to thwart attempted break-ins.



St. Paul Corrugating Co., Inc.
 Email: info@stpaulcorrugating.com
 Web: stpaulcorrugating.com
 700 39th Ave NE
 Minneapolis MN 55421
 Toll free: 1-800-439-9271

